



DEUBLIN

Bearingless Rotating Union Cartridge Design Compact Bearingless Rotating Union for smallest installation space

- Single passage available with almost all sealing technologies
- Design with additional functions: e.g. long stroke stator with hub to allow drawbar movement even when rotating union is mounted onto the clamping unit
- Full-flow design has no obstructions to trap swarf or debris
- Balanced mechanical seals made from silicon carbide / carbon graphite for timed dry run for long life
- Anodised aluminium housing resists corrosion
- Dry run capability depending on sealing technology and materials
- Closed seal, Pop-Off, and AutoSense sealing technologies available depending on model

Operating Data

Sealing Technology (depending on model) AutoSense™, Closed Seal, Pop-Off™
 Media (depending on model) Coolant – water-based; Cutting Oil
 Compressed Air up to 10 bar, up to 145 psi
 MQL (oil mist) up to 10 bar, up to 145 psi

Examples

1121-251-434

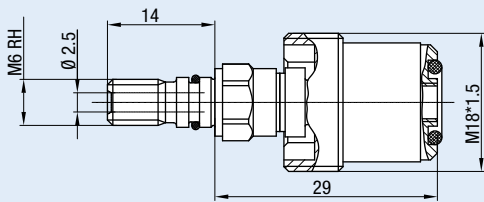

1117-593-589

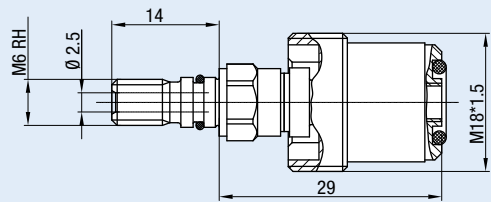

Features	Operating Data	
• Pop-Off™	Speed	150,000 rpm
• Single passage	Pressure	180 bar
• Seals SIC/SIC	Media	Coolant / Cutting Oil
	Dry run	Yes
	Max. Flow	7.4 l/min

Features	Operating Data	
• Closed Seal	Speed	30,000 rpm
• Single passage	Pressure	140 bar
• Seals CG/SIC	Media	Coolant / Cutting Oil
	Dry run	No
	Max. Flow	7.4 l/min

1124-259-260

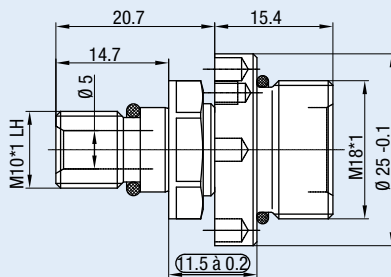

1154-170-137

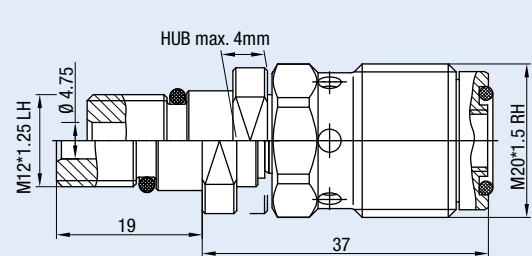

Features	Operating Data	
• AutoSense™	Speed	30,000 rpm
• Single passage	Pressure	140 bar / 10 bar
• Seals SIC/SIC	Media	Coolant / Compressed Air
	Dry run	Yes
	Max. Flow	7.4 l/min

Features	Operating Data	
• AutoSense™	Speed	40,000 rpm
• Single passage	Pressure	140 bar / 10 bar
• Seals SIC/SIC	Media	Coolant / Compressed Air
• Max Stroke 4 mm	Dry run	Yes
	Max. Flow	7.4 l/min

美国杜博林 Deublin 旋转接头授权代理

信德迈科技（北京）有限公司 Email: sales@cnmec.biz 010-84282935