



DEUBLIN

1005 Series "Closed Seal" Rotating Unions for Continuous Coolant Service

- Single passage for coolant or MQL
- Closed seals for transfer line and similar applications
- Full-flow design has no obstructions to trap chips or debris
- Bearing-supported with threaded rotor for easy installation
- Labyrinth system and vents to protect ball bearings
- Balanced mechanical seals made from silicon carbide for long life even under difficult operating conditions
- Anodized housing and stainless steel rotor resist corrosion

Operating Data

Media	Water-based Coolant MQL (oil mist) up to 10 bar (145 psi)
Filtration	ISO 4406 Class 17/15/12, max. 60 micron
Maximum Speed	15,000 min ⁻¹ 15,000 rpm
Maximum Pressure	105 bar 1,520 psi
Maximum Flow	6.7 l/min 1.8 gpm
Maximum Temperature	71°C 160°F



DO NOT RUN DRY

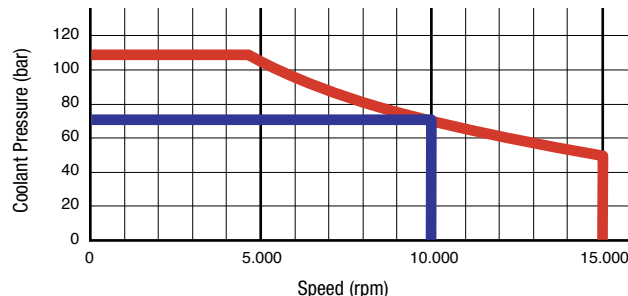

Other 1005 models are available for use with oil or dry air. Please refer to the **DEUBLIN Engineering Catalog 2600**.

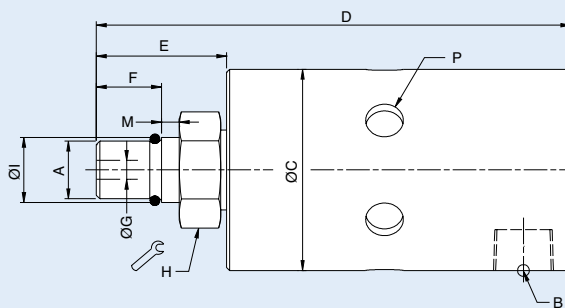

Ordering Number	B Supply Connection	C Overall Diameter	D Overall Length	P Vent Size \emptyset (6 x 60°)	A Rotor Connection	E Rotor Length	F Thread Length	G Bore Diameter	H Across Flats	I Pilot Diameter	M Pilot Length
1005-402-401	1/8" NPT Radial	34	80	6.4	M10 x 1 RH	22	11	3.2	17	10.994 / 10.989	3
1005-402-448	1/8" NPT Radial	34	80	6.4	M10 x 1 LH	22	11	3.2	17	10.994 / 10.989	3
1005-704-434*	1/8" NPT Radial	34	80	3 x Rp 1/8"	M10 x 1 RH	22	11	3.4	17	10.994 / 10.989	5

* Also allowed for hydraulics, compressed air and defined dry run cycles. For further information please contact **DEUBLIN**.